

WE OPEN SPACE



Roto ALU 540

Simply ingenious, ingeniously simple!

The flexible hardware system
for aluminium windows and balcony doors

ROTO ALU 540 – TWO CENTRAL LOCKING SYSTEMS, ONE HINGE-SIDE

As pioneers for innovative fenestration technologies, Roto has never been satisfied to sit back on its laurels. Therefore we consistently analysed and further developed our present ALU 500 and ALU 400i hardware. Our goal was a system with high demands: first-class technology, highest flexibility for the fabricator, and even more economical and timesaving installation. The new ALU 540/540i hardware system meets these requirements. The essential principle in this case: an optimised hinge-side and two well-proven central locking systems.

ALU 540/540i: Combining the best from two systems. A standardised hinge-side is used up to a sash weight of 130kg. Your advantages as a fabricator: fewer components to be mounted, less logistical costs and storage space. Preassembled parts make installation easier, more efficient and saves time. The new hardware system is of modular design, and compatible with the heavy 200kg and 300kg hinge-side series.



**Tilt&Turn stay bearing and hinge
with clamping support-strip**
The new hinge-side, equipped
with preassembled clamp-strips
reduces installation time



SIMPLE

Everything remains better! Your advantage: You don't need to change anything, and you still benefit from easier use. The 6mm and 10mm coupling points remain unchanged. The same applies to the application ranges, the connecting-rods' cropping dimensions and the logical modular design of the components. New investments are superfluous. Look at what the ALU 540 hardware system has to offer: you'll be surprised!

SIMPLE, AESTHETIC, FLEXIBLE

The new standardised hinge-side has been simplified whilst, at the same time, the installation security has been increased. The preassembled clamp-strips offer a clear fabrication advantage. In addition, we have new, intelligent and convenient adjustment possibilities. For instance with just one screw-turn, the sash can be laterally adjusted while still installed.

The advantages of the new ALU 540 hinge-side

- Optimal screwing axis position, thus convenient and simple installation
- Sash stays and corner hinges, as well as the stay bearings and pivot rests are non-handed
- Time saving, due to the pre-assembled aluminium clamping support-strips
- Fewer components due to the pre-assembled stay-bearing pin and pin retention device
- Lateral and vertical adjustments possible while the sash is still connected to the frame.
- Attractive aesthetics: Pivot rest and stay bearing flush with the sash overlap. No visible screws

FLEXIBLE

Perfect for all standard opening-types. All hardware variations are possible with the ALU 540 system: Tilt&Turn, Turn-Only, Tilt-Only, French windows (sash with floating mullion) and Tilt-First with sash weights up to max. 130kg. Furthermore, we offer an intelligent hinge-side upgrading possibility for heavy sashes (Tilt&Turn sashes: 200kg/Turn-Only sashes 200kg and 300kg).



Hardware overviews T540-10

T540-10 T&T – hinges clampable, frame groove V.01 / V.02,
Sash weight max. 90 kg / 130 kg

Hardware overview T&T

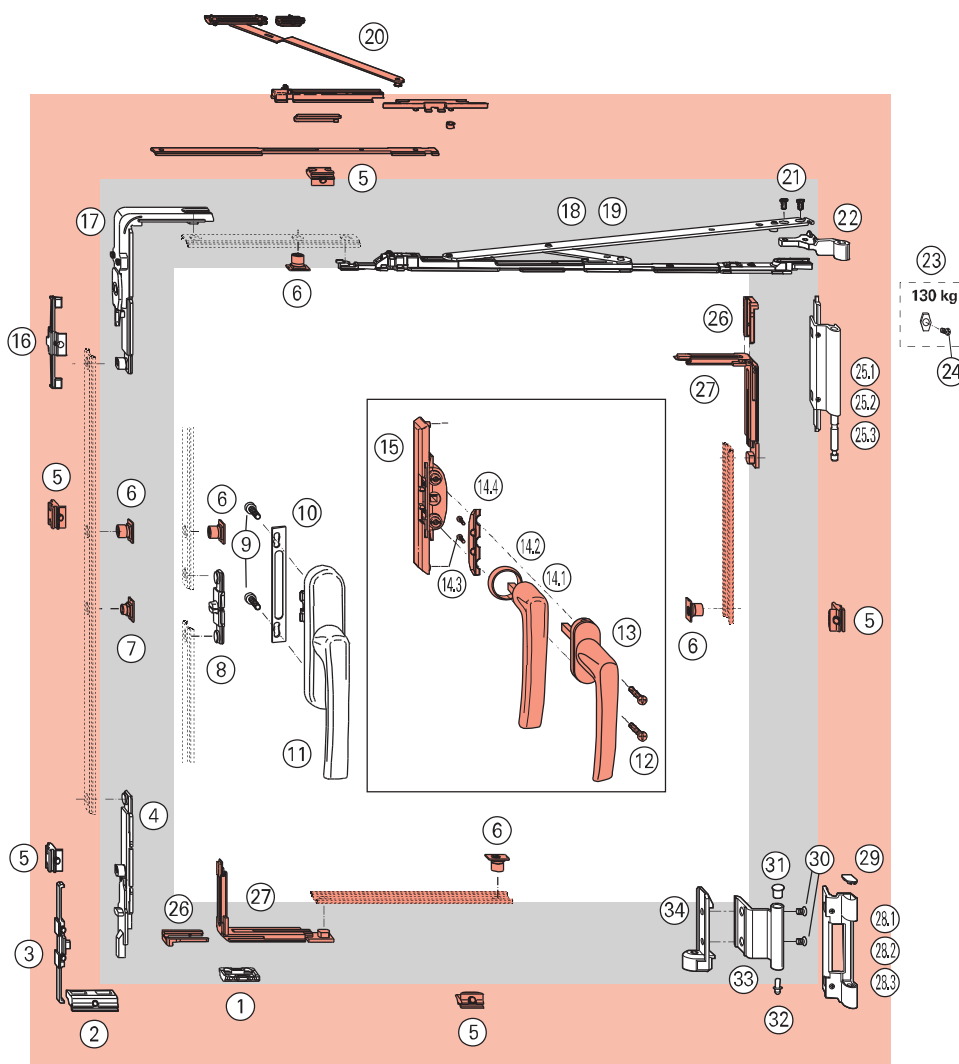
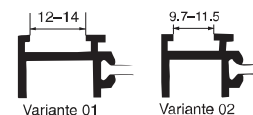

Parts list bulk packaging

Locking components and sash stays

Pos.	Pcs.	Component description	Colour	Mat. no.	Packunit
1	1	Run-up block	–	212 008	100
4	1	Tilt lock bolt	–	331 018	100
2	1	Horizontal T&T striker	–	212 122	100
3	1	Anti-jemmy device V.01	–	331 019	100
1	1	Anti-jemmy device V.02	–	331 020	100
5	1	Striker V.01	–	212 633	100
1	1	Striker V.02	–	212 634	100
16	1	Striker stop, V.01	–	331 014	100
1	1	Striker stop, V.02	–	331 015	100
17	1	Corner drive with M.D.	–	331 011	50
19	1	Sash stay 600	–	377 451	10
18	1	Sash stay 400	–	377 452	10

Espagnolettes and connectors

(refer to the chapter “Espagnolettes, connector sets & window handles”)

Pos.	Pcs.	Component description	Colour	Mat. no.	Packunit
11	1	RotoLine geared-handle 26	–	–	(see also page 205)
8	1	T connector	–	334 754	100
10	1	Geared-handle support	–	331 937	100
9	2	Flat-headed screw M5 x 12	–	212 500	10

Alternatively:

Pos.	Pcs.	Component description	Colour	Mat. no.	Packunit
15	1	Flush encased gearbox w/o mishandling device	–	378 338	10
13	1	RotoLine window handle for flush encased gearbox	–	–	(see also page 205)
12	2	CS screw, stainl. steel M5x30	–	212 501	100
14.1	1	Escutcheonless handle	–	–	(see also page 213)
14.2	1	Ring for escutcheonless handle	–	–	(see also page 213)
14.4	1	Mounting plate	–	378 134	10
14.3	2	Screws for escutcheonless handle	–	–	–